

Supermax Permanent Magnetic Chuck

Intended use:

Powerful magnetic chuck, with a robust construction and greater magnetic power this chuck is designed for use with milling applications.

Features:

- High holding force 120 N/cm²
- Rigid top plate with pole division 8/5 steel/brass
- Solid and robust
- Coolant Tight and Oil Tight.

Scope of supply:

- Operating Key
- User manual

Clamps to hold the chuck to the machine bed are available separately.

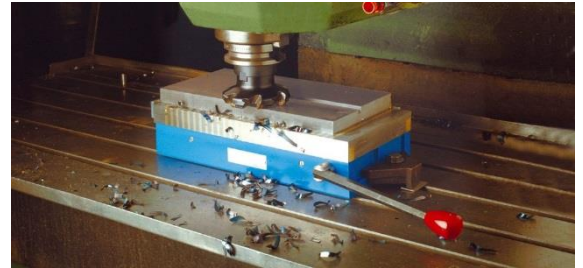

Applications:

- Grinding of small and up to large components
- Chuck can be submerged in coolant or oil
- Recommended minimum workpiece thickness is 5mm

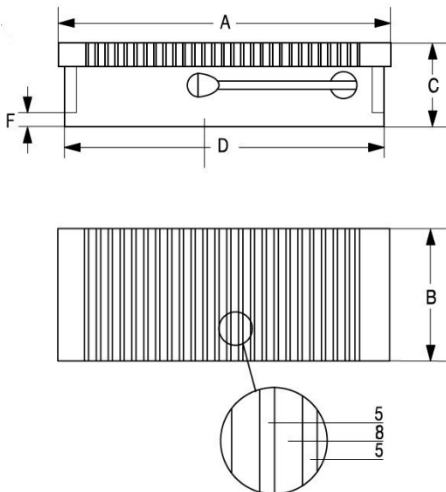

Model	A (mm)	B (mm)	C (mm)	D (mm)	F (mm)	No. Levers	Weight
S12.25.001	400	300	93	395	20	1	72
S12.25.002	500	300	93	495	20	1	90
S12.25.003	600	300	93	595	20	1	100
S12.25.004	800	300	93	795	20	2	130
S12.25.005	900	300	93	895	20	2	153
S12.25.006	1000	300	93	995	20	2	180

For more information on our products contact us on Tel: 01525 372714 Email: Sales@LHS.uk.com or Website: <http://www.LHS.uk.com>