

# Ferromax

## Circular permanent magnetic chucks for grinding and turning



- High holding force
- Precision construction with silver brazed topplate
- Low concentrated field
- Variable holding power with smooth actuation

For additional holding of small workpieces or for accurate and quick positioning of components, locating holes F mm deep (see dimension sketch) can be drilled and tapped in the steel poles on the chuck surface to accommodate stops or other quick centering devices. All rotary chucks are constructed with detachable operating handles so they can be used safely.

Code	A mm	H mm	B mm	C mm	D mm [max]	F mm [max]	M mm	E mm	Pole division		Number of keys	Net Weight (kg)
									Steel mm	Brass mm		
31.00.155	155	70	127	3	15	13	4 x M8	142	6	5	1	7
31.00.203	200	78	150	4,5	22	22	4 x M8	182	8	5	1	12
31.00.253	250	78	200	4,5	22	22	4 x M8	232	8	5	1	17
31.00.303	300	78	250	4,5	22	22	4 x M8	285	12	5	1	27
31.00.353	350	78	300	4,5	22	22	4 x M8	334	12	5	1	40
31.00.403	400	78	300	4,5	22	22	6 x M10	375	12	5	1	58
31.00.450	450	102	350	5	22	22	6 x M10	400	12	5	1	78
31.00.500	500	102	400	5	22	22	6 x M10	450	12	5	1	85
31.00.600	600	100	400	5	22	22	6 x M10	550	8	5	4	125
31.00.800	800	110	600	5	22	22	6 x M10	790	8	5	4	253

All rights reserved to change construction and dimensions without notice

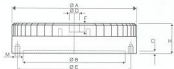

# WALKER MAGNETICS